

Important Information

-- This manual is designed to help you to install, operate and maintain Perfect Binding Machine PB2000. Read, understand and keep this manual in a safe and convenient place.

-- Do not operate GB-6210 until you read and understand the instructions in this manual.

-- E-P Equipment Co., Ltd. should not be liable for incidental consequential damages resulting from : improper or inadequate maintenance by customer; unauthorized modification or misuse; operation outside of the environment specifications for the product.

-- EP Equipment Co.,Ltd pursues a policy of continuing improvement in design and performance of the product. Therefore, the product design and specifications are subject to change without prior notice and without our legal obligation.

-- All rights are reserved. No part of the manual may be photocopied, reproduced or translated to another language without the prior written consent of EP Equipment Co.,Ltd.

Contents

1. Specifications	
1-1 Major Specifications	2
1-2 Accessories	3
2. Guide to Components	
2-1 Main Frame	4
3-2 Control Panel	5
3. Before Operation	
3-1 Installation Precautions	7
3-2 Operating Precautions	7
3-3. Knowledge of how to bind a good book	8
4. Operation Procedure	
4-1 Preadjustments for operation	9
4-2 Auto Mode	11
4-3 Manual Mode	13
5. Maintenance	
5-1 Glue Supply	16
5-2 Clear the Waste tank	17
5-3 Unload glue	18
6. Troubleshooting	
.....	22

1. Specifications

1-1 Major Specifications

Model	PB2000
Maximum Spine Length	330 mm (12.4")
Maximum Binding Thickness	38 mm (1.5"), 380 Sheets
Minimum Binding Thickness	3 Sheets
Cover Weight range	70 to 180 gsm (Paper only)
Production Speed	1 Book / 35s, Up to 100 books/hour
Binding Glue Type	Hot Melt Glue (170 to 190 Deg C)
Warming Up Time	25 Minutes
Power	220 ~230V - 50~60 Hz
Power Consumption	1050 W
Machine Dimensions	580x550x270 mm
	25.6"x21.7"x10.6"
Machine Weight	60 Kg (120lbs.)

1-2 Accessories

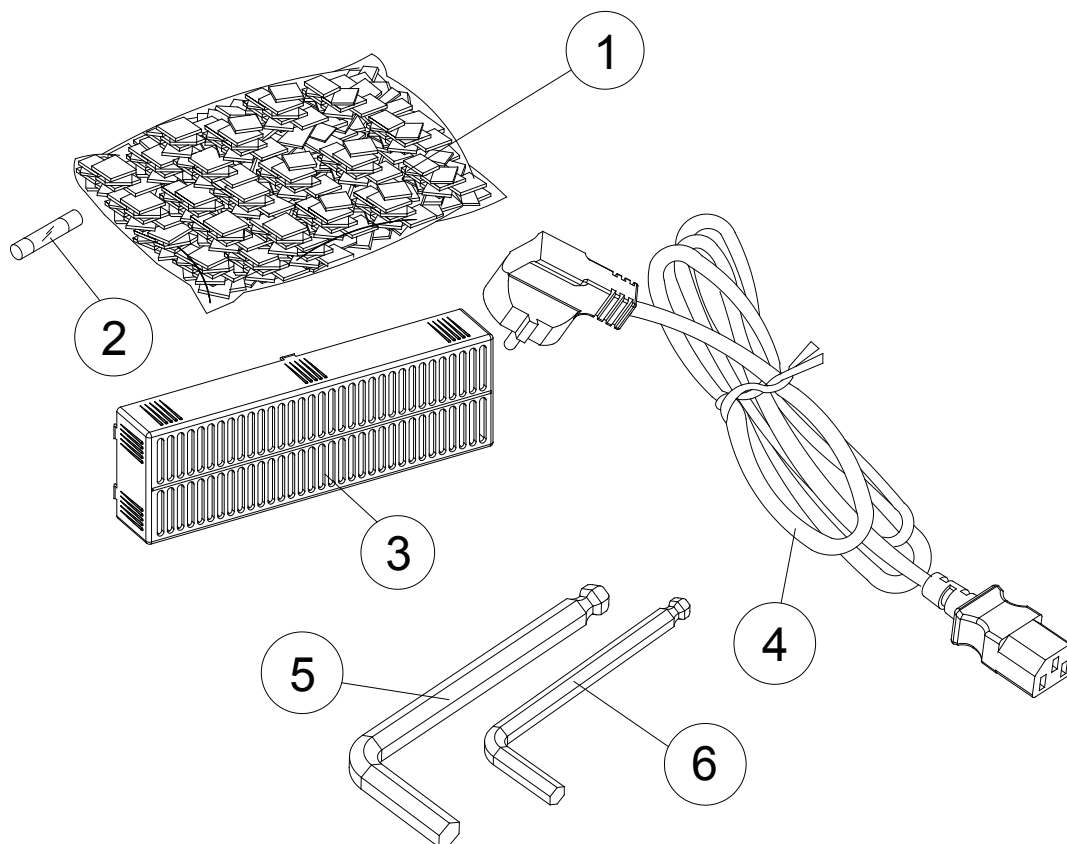

	Name	Quantity
1	Hot melt Glue	2 KG
2	Fuse	1 PC
3	Waste Box	1 PC
4	Power Cord	1 PC
5	Hexagonal wrench	1 PC
6	Hexagonal wrench	1 PC

2. Guide to Components

2-1 Main Frame

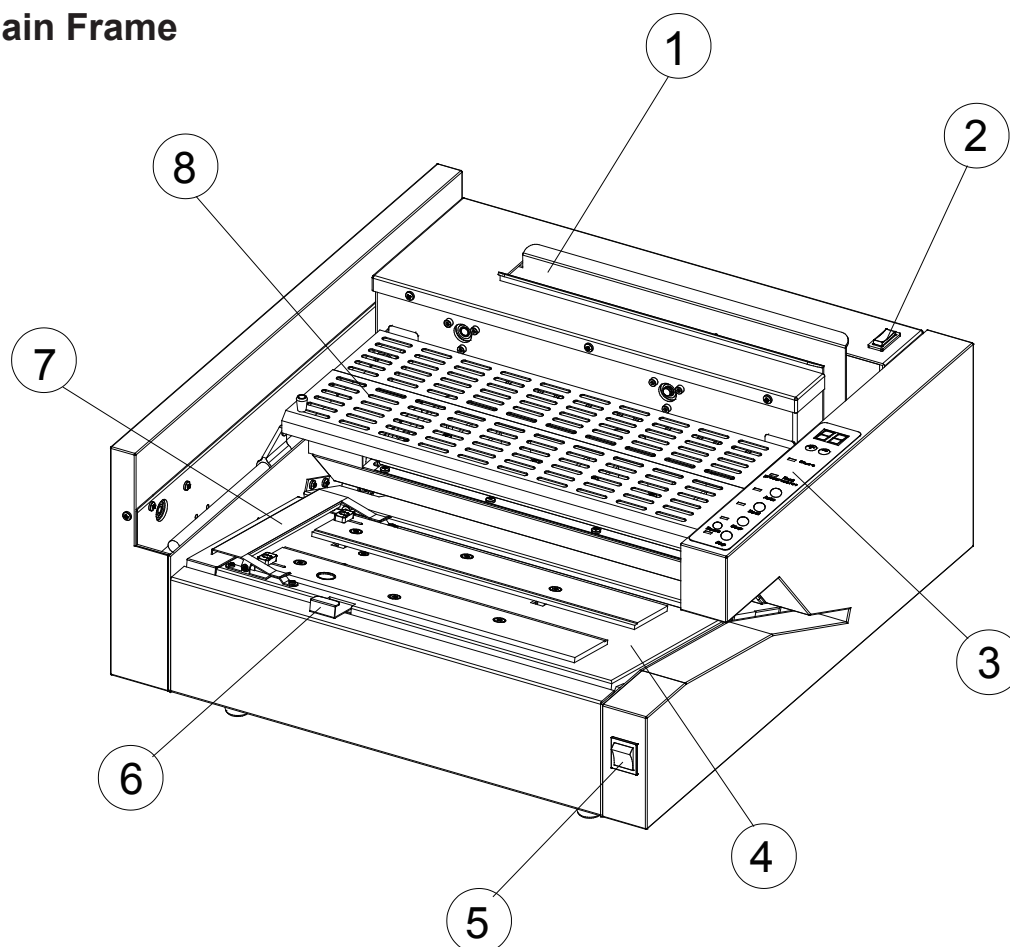

	Name	Function
2-1-1	Clamper	This clamps sheets to be bound and carries to the Roughing cutter and the melt tank
2-1-2	Clamper Open/Close Switch	Used to open / close the clamper, used only in Hand mode
2-1-3	Control Panel	The control panel
2-1-4	Nipper	Used to nip cover and sheets to form spine
2-1-5	Main Switch	Used to turn ON / OFF main power
2-1-6	Cover Gauge	Used to regulate cover position
2-1-7	Cover Set Guide	Used to fix cover
2-1-8	Melt Tank Cover	Used to cover the melt tank and roughing cutter. Keep your hands off from the melt tank and glue application roller and roughing cutter when the cover is open

2-2 Control Panel

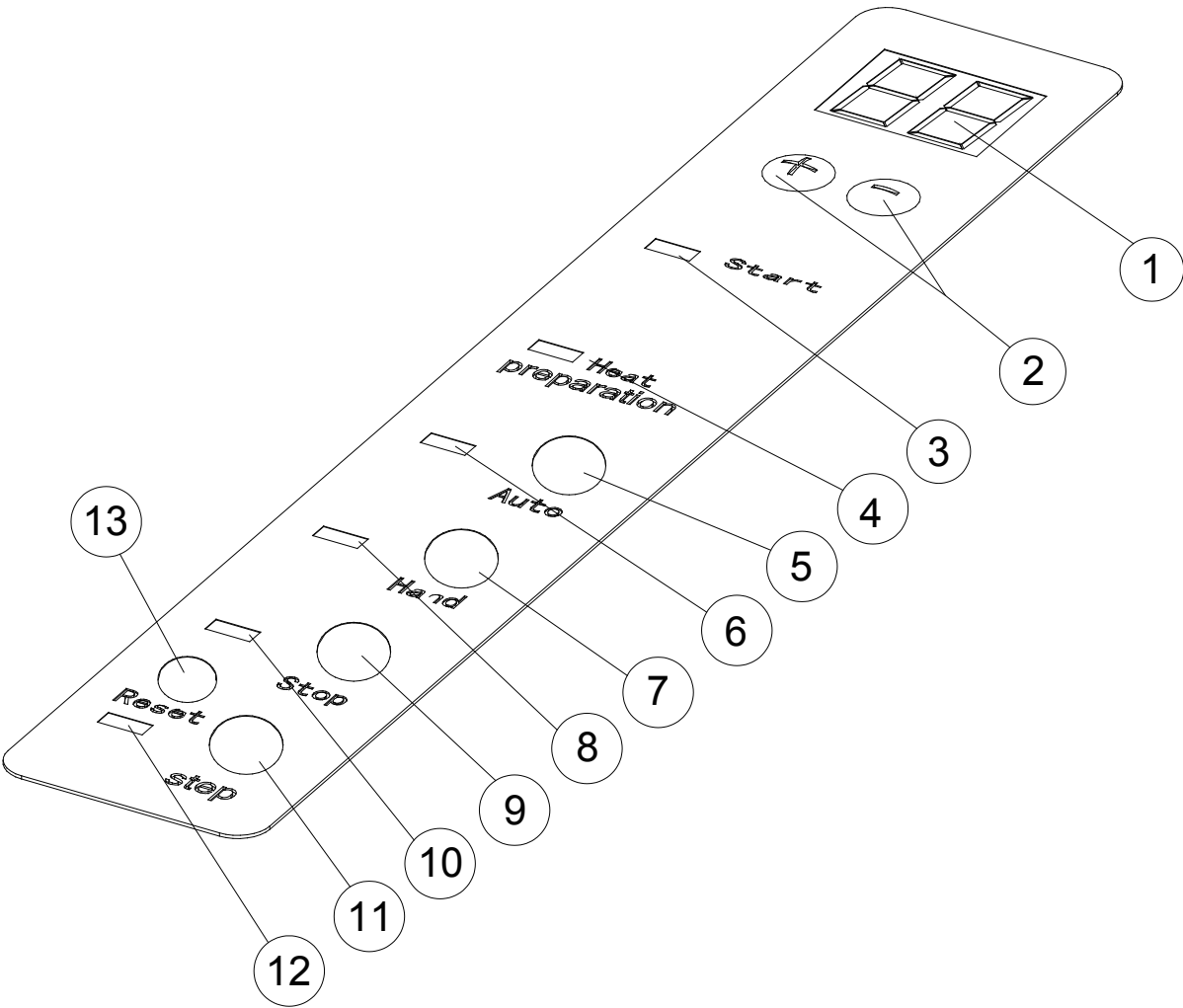

	Name	Function
2-2-1	Nipping Time Display	Shows the length of nipping time
2-2-2	Nipping Time Control Button	Depress +/- button to set the length of nipping time
2-2-3	Start Lamp	This Lamp turns on when the machine is ready to bind
2-2-4	Preparation Lamp	This Lamp turns on when glue is not melted for binding
2-2-5	Auto Mode Select Button	Used to select Auto mode
2-2-6	Auto Mode Lamp	This Lamp turns on when Auto mode is selected
2-2-7	Hand Mode Select Button	Used to select Hand mode
2-2-8	Hand Mode Lamp	This Lamp turns on when Hand Mode is selected
2-2-9	Stop Button	Used to stop the binding procedure at anytime
2-2-10	Stop Lamp	This Lamp turns on when the stop button is depressed
2-2-11	Step Button	The binding procedure will carry on step by step, it will go to the next step when you press the step button. Can be only used in hand mode.
2-2-12	Reset Lamp	This Lamp turns on when the reset button is depressed and it turns off when reset progress is over
2-2-13	Reset Button	Used to bring back the nipper and clamber to their home position when stop button is depressed during binding procedure;
2-2-14	Reset (Function) Button	In Manual Mode, depress this button for 5 seconds, the clamber will travel forward and stop at nipper position.

3. Before Operation

3-1 Installation Precautions

- 3-1-1. Place the machine in a flat space. Avoid places where table and foundation are unstable.
- 3-1-2. Keep the machine away from direct sun light.
- 3-1-3. Keep the machine away from high temperature and humidity.
- 3-1-4. Keep the machine away from lots of dust.
- 3-1-5. Keep the machine away from magnetic or magnetized apparatus.
- 3-1-6. Do not put many loads on one electrical outlet.

3-2 Operation Precautions

- 3-2-1. Do not touch melted glue or melt tank or roughing cutter with your finger or hand. They are so hot that they cause severer skin burn.
- 3-2-2. Do not supply too much glue in melt tank.
- 3-2-3. When the machine is not used, turn off power switch for preserving glue quality. Deterioration pace of glue is proportional to time length during glue is melted.
- 3-2-4. Absolutely do not open any covers and disassemble or modify the machine.
- 3-2-5. Do not let fall down some thing small into the machine.

3-3. Knowledge of how to bind a good book

3-3-1 It is very important that the book stock should be trued up before binding. Good and strong binding depends on spine-alignment of stock. To apply glue on spine equally, all sheet must touch the level plate. Make sure the stock aligned enough.

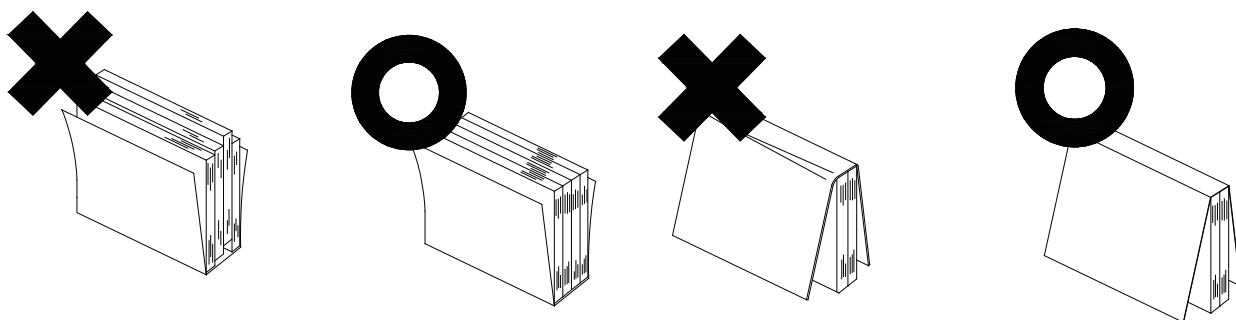

3-3-2 The thickness (weight) of paper which can be used for cover is from 70-180 gsm. Do not use the cover too thin or too thick.

3-3-3 keep the clamber and the nipper clean. Otherwise the binding quality may be affected by dusts or pieces of glue on the level plate and the nipper.

3-3-4 Do not open the bound book within five minutes.

3-3-5 Do not bind books which have been bound before or have glue on the book spine. It may damage the Roughening cutter.

3-3-6 Please supply enough glue in the melt tank.

4. Operation Procedure

4-1 Preadjustments for operation

Make adjustments to ensure good binding quality when turn on the machine.

4-1-1 Turn on the machine

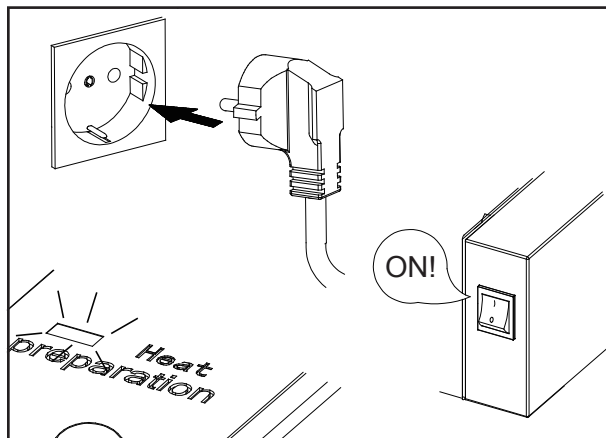

- Plug the power cord to outlet.
- Turn on the main switch.
- The Heat Preparation Lamp turns on, the machine is heating the glue in the melt tank. You can not operate the machine now.

4-1-2 Warming Up

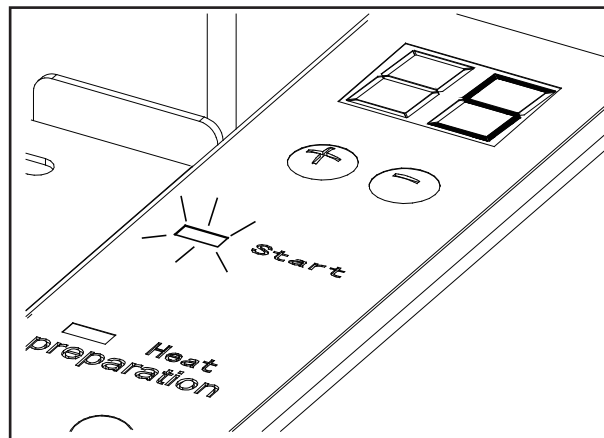

- Warming up time is about 20 minute.
- Start lamp turns on when the machine is ready to operate, but it keeps heating; please wait 5 more minutes so that the glue in the melt tank can fully melted.

4-1-3 Set the nipping time

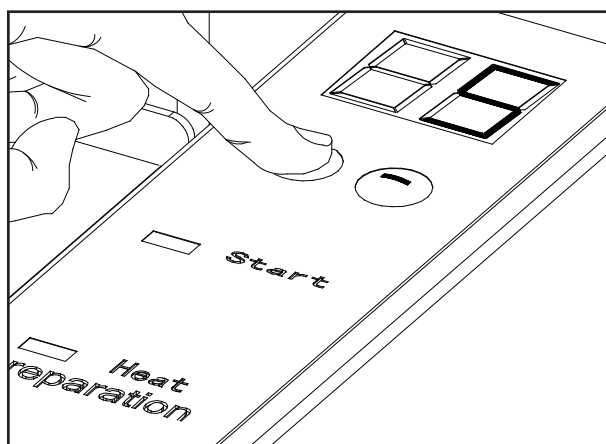

- Depress Nipping Time Control Button, you can adjust the nipping time (between nipping table raise and nipper plate open).
- For books with 100 sheets, nipping time should be 5 seconds; for books with 200 sheets or more, the nipping time should be 8 seconds or more. For padding, the nipping time should be 0 second.

4-1-4 Set the clamber width

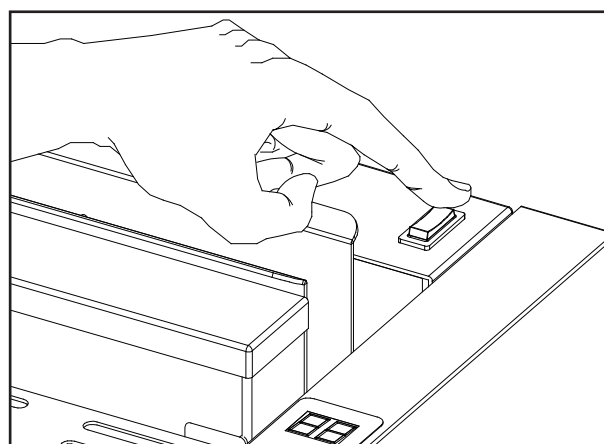

- Depress clamber open/close button to adjust the clamber width.
- After each binds, clamber width remains the same.

4-1-5 Rolling the glue.

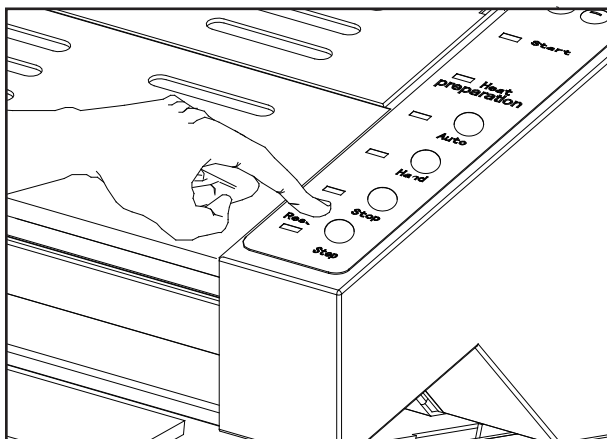

- Keep depress Reset Button for about 5 seconds, clamber moves forward and stop at nipper position.
- Depress Reset Button, clamber return home position.
- Please repeat this step twice. Glue in melt tank is rolling to get even temperature.
- After these adjustments, you can operate the machine either in Auto Mode or in Manual Mode.

4-2 Auto Mode

4-2-1 Select auto mode

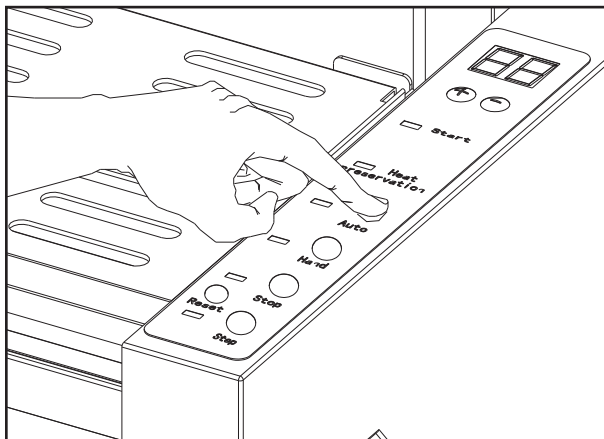

- Depress Auto Button to select auto mode, Auto mode Lamp turns on.

4-2-2 Pull out the cover gauge

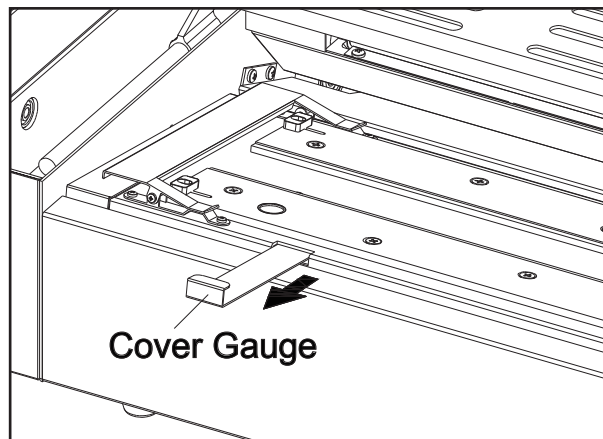

4-2-3 Place the cover

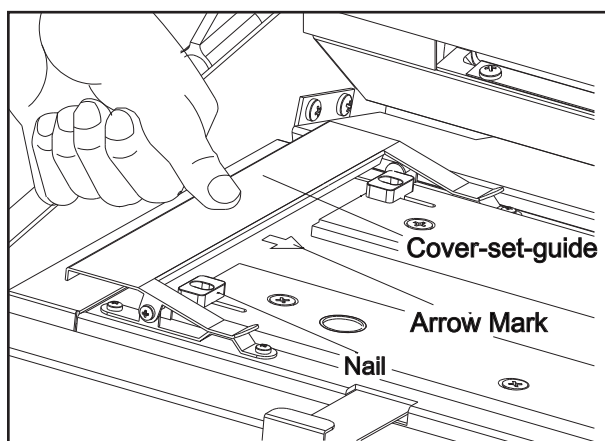

- Place cover on the nipper.
- Depress the cover-set-guide at indicated position.
- Insert cover, make sure cover touch two nails
- Align the centre of cover to arrow mark.
- Fix the cover with cover-set-guide.

4-2-4 Align the cover gauge to cover

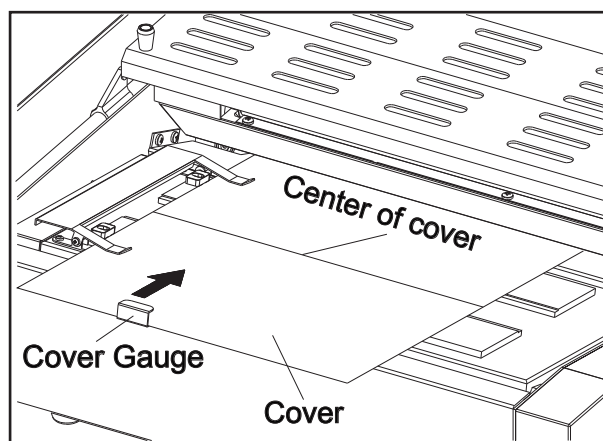

- Set the cover gauge so that it slightly touches the edge of cove.

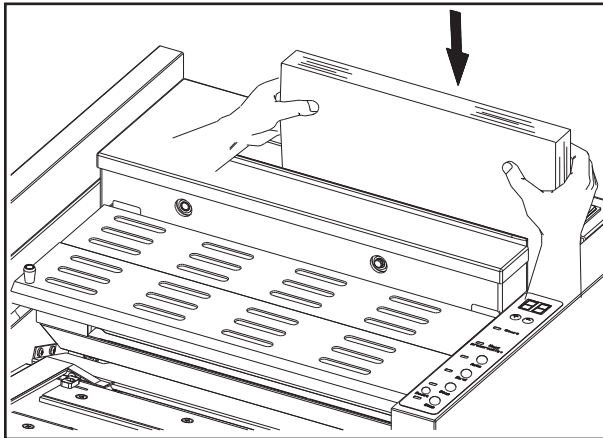
4-2-5 Place Book into the clamber

- Please book in the right hand side of clamber.
- True up book in spine fully in the right hand side of the clamber.
- The clamber auto sense the thickness of sheets and close

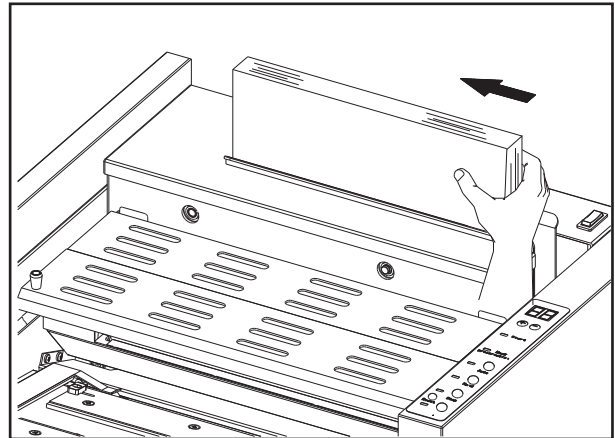
4-2-6 Push book to the left and bind

- Set left hand side edge of book against left side of the clamber.
- The clamber automatically sense the thickness of sheets and close.
- Binding automatically starts.

[Warning]

1. Do not put your hand in the clamber.
2. Depress Stop Button can stop the binding process.

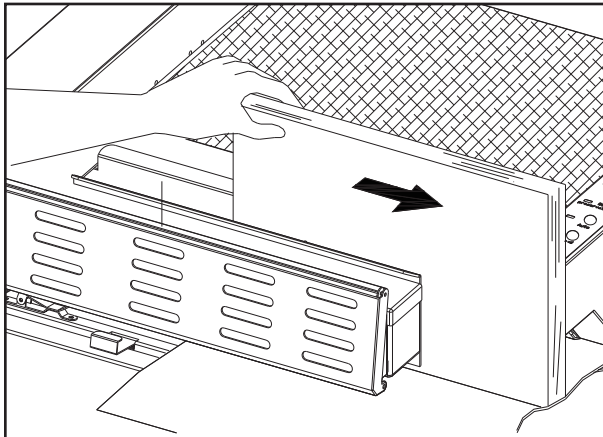
4-2-7 Binding finish take out the book

- Clamber travels to the nipper with glue applied on the book spine.
- Nipper table raise and nips the book with cover.
- Nipping finish, clamber release the book.
- Pull the book a little incase there is extra glue in the clamber.
- Slide out the book once from the right hand side.
- Clamber returns to its home position ready for next bind.

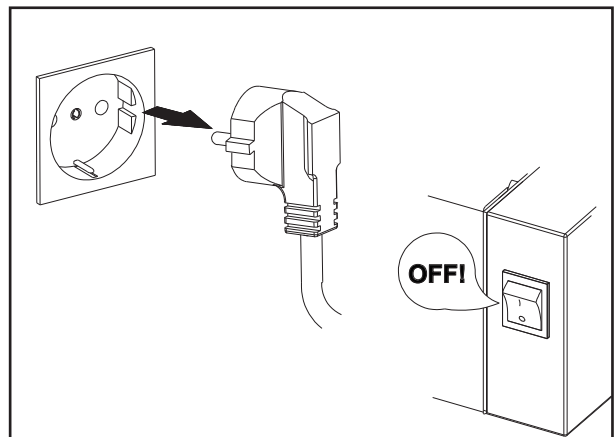
4-2-8 Turn off the power

After you finish the binding job

- Turn off the main switch.
- Detach the power cord from outlet.

4-3. Manual Mode

4-3-1 Choose Manual Mode

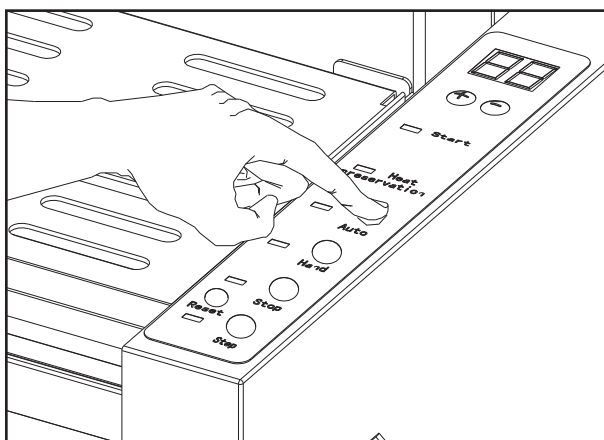

- Depress Hand Button when you want to use Manual Mode. Hand Lamp turns on.

[NOTE]

Manual mode is used for beginners or testing purpose.

4-3-2 Choose Manual Mode

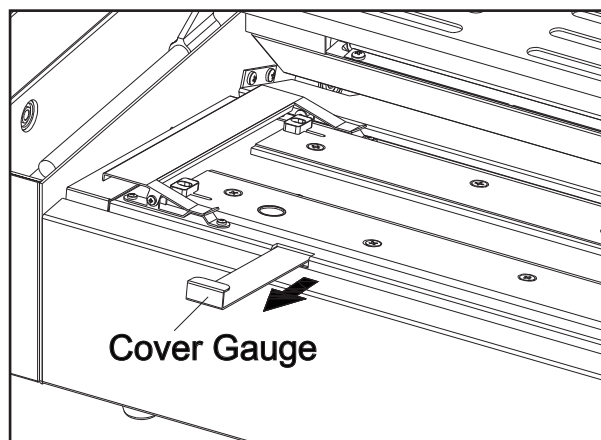

4-3-3 Place the cover

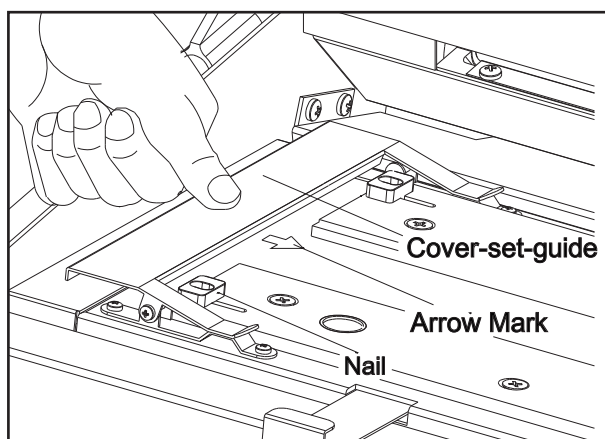

- Place cover on the nipper.
- Depress the cover-set-guide at indicated position.
- Insert cover, make sure cover touch two nails
- Align the centre of cover to arrow mark.
- Fix the cover with cover-set-guide.

4-3-4 Align the cover gauge to cover

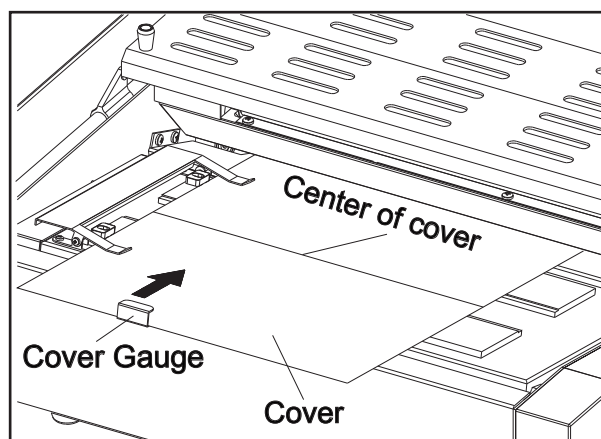

- Set the cover gauge so that it slightly touches the edge of cove.

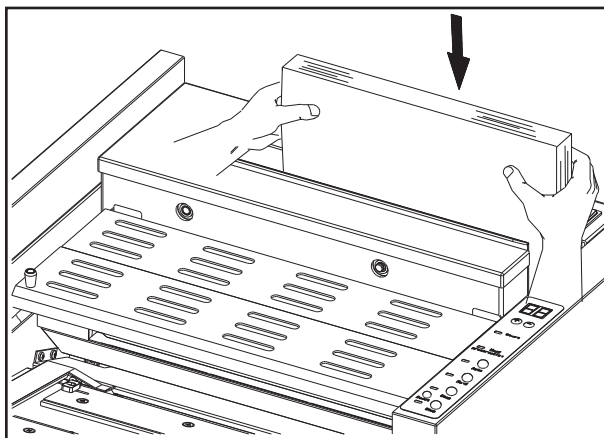
4-3-5 Place Book into the clamber

- Please book in the right hand side of clamber.
- True up book in spine fully in the right hand side of the clamber.
- The clamber auto sense the thickness of sheets and close.

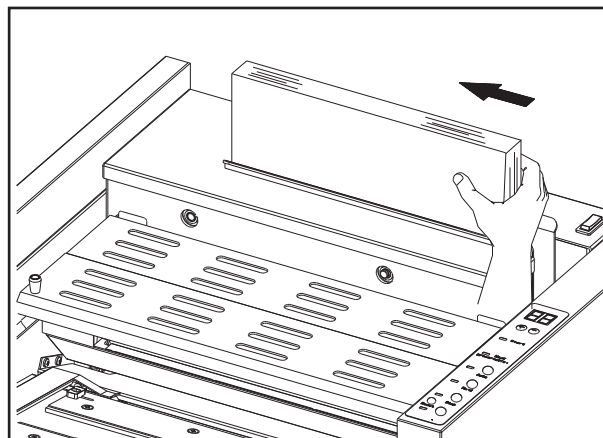
4-3-6 Push book to the left and bind

- Set left hand side edge of book against left side of the clamber.
- Depress Step Button to close the clamber.

[Warning]

1. Do not put your hand in the clamber.
2. Depress Stop Button can stop the binding process.

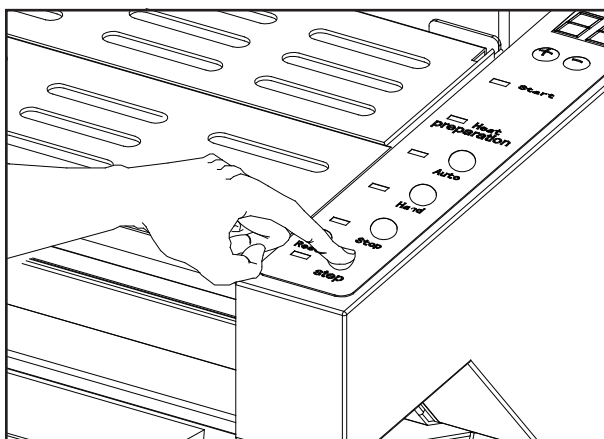
4-3-6 Binding

- Depress Step Button, the clamber start to move forward
- Clamber travels over the Roughing Cutter, then forward and backward the melt tank twice. The glue will be applied on sheets spine, waiting for nipping.
- Sheets applied glue at spine is nipped with cover.
- The clamber automatically release the book within the nipping time

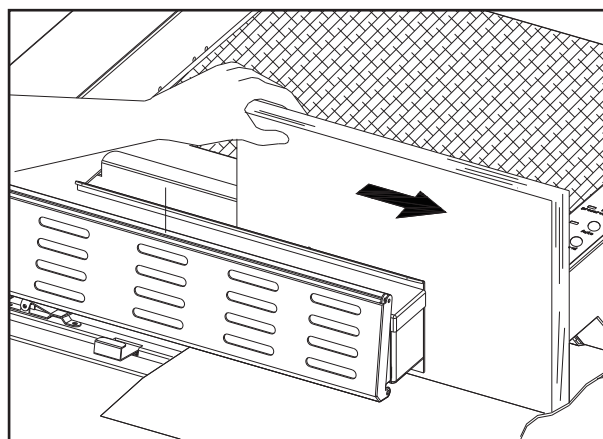
4-3-7 Take out the book

- Pull the book a little incase there is extra glue in the clamber.
- Slide out the book once from the right hand side.

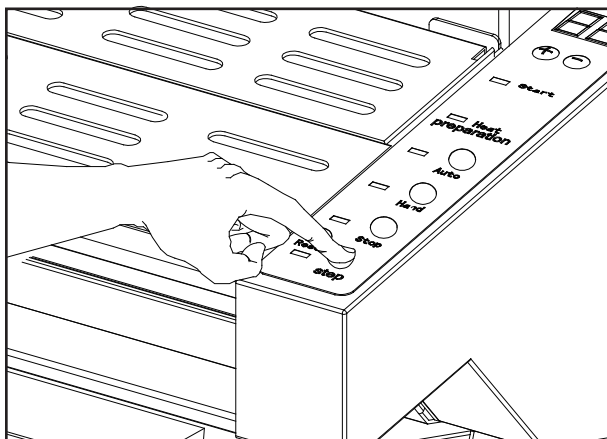
4-3-8 Return the clamber

- Depress the Step Button, Clamber returns to home position ready for next bind.

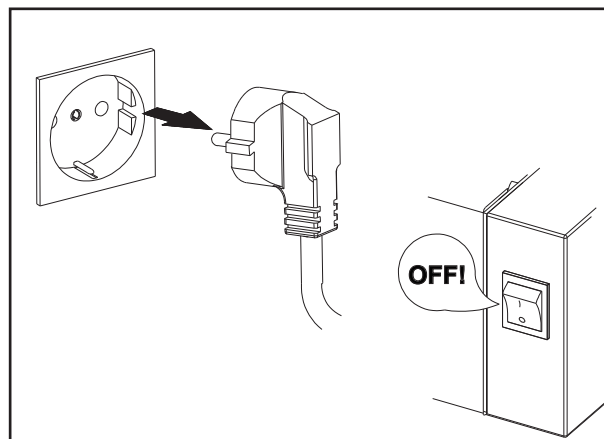
4-3-8 Turn off the power

- After you finish the binding job
- Turn off the main switch.
 - Detach the power cord from outlet.

5. Maintenance

5-1 Glue supply

When the glue in the melt tank is not enough, please supply glue in time.

Warning!

Do not touch the melt tank or the application roller. High temperature will cause severe personal injury.

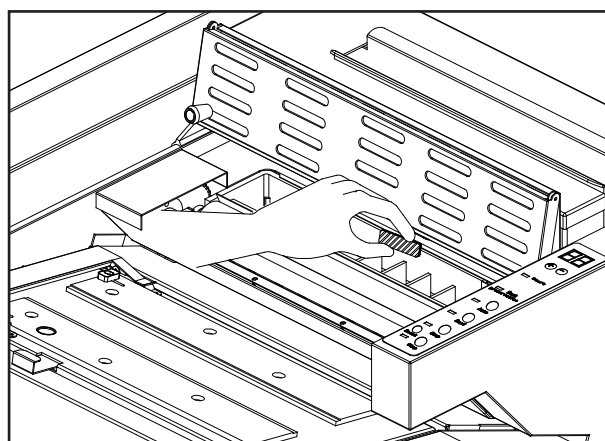
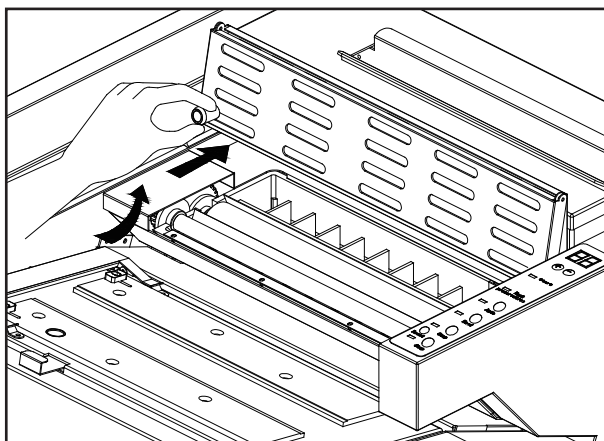

- Turn on the machine, make sure the glue is fully melted in the melt tank.
- Turn off main power and wait 10 minutes/
- Open the melt tank cover with Handle

- Place the glue into the melt tank.
- Close the melt tank cover.
- Turn on the machine to heat the glue.

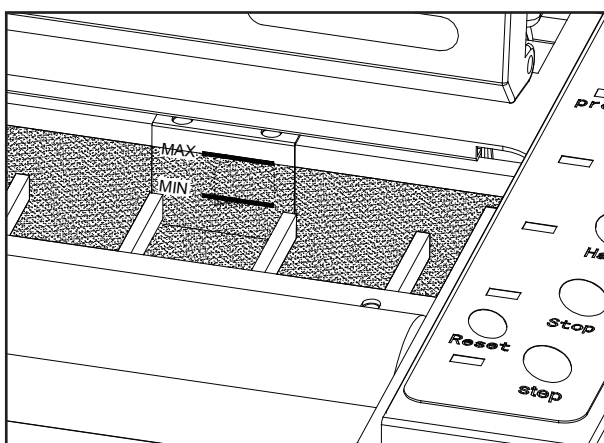

- Please do not supply too much glue. Please check the glue level indicator.
- Please use the glue supplied by E-P Equipment.

5-2 Clear the Waste tank

When there is too much dust and waste paper in the waste Tank, Please clear the tank.

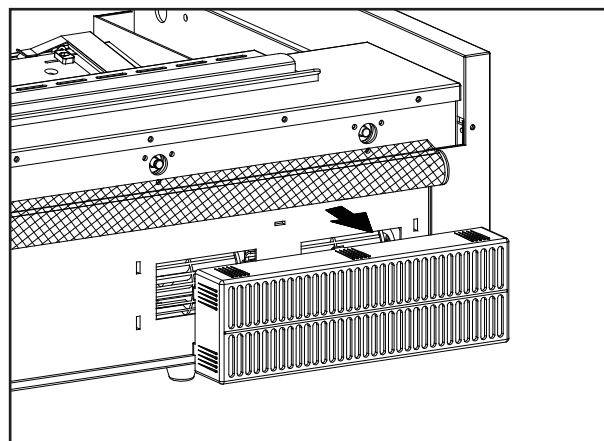
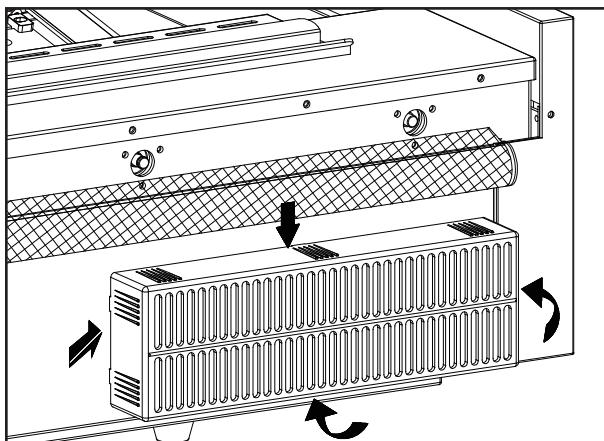

-- Pull out the Waste Tank in the back of machine

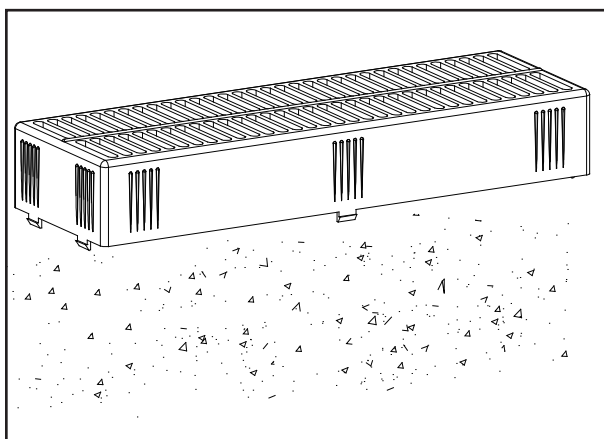

- Clean the Tank

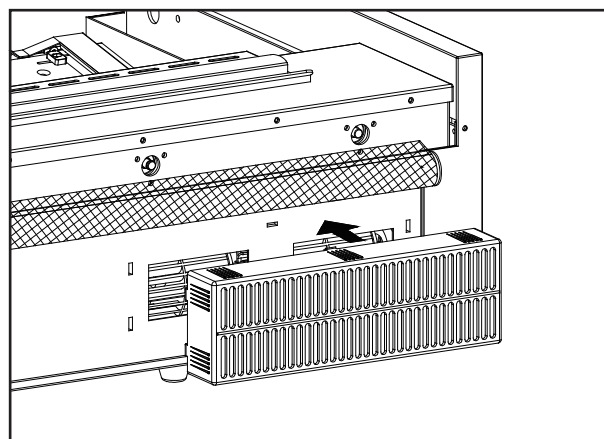

-- Insert the waste tank back into the machine

5-3 Unload glue

We recommend you to unload the glue in the melt tank and supply the new glue in to keep good binding quality.

We have Stand Cabinet (Optional accessory) available for empty the glue.

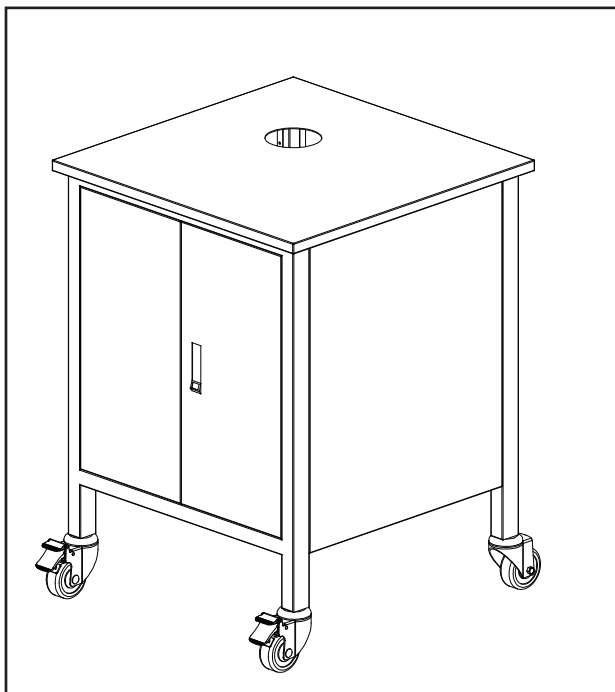

Place GB-6210 on the machine in the following way. Then place a container to get drained glue.

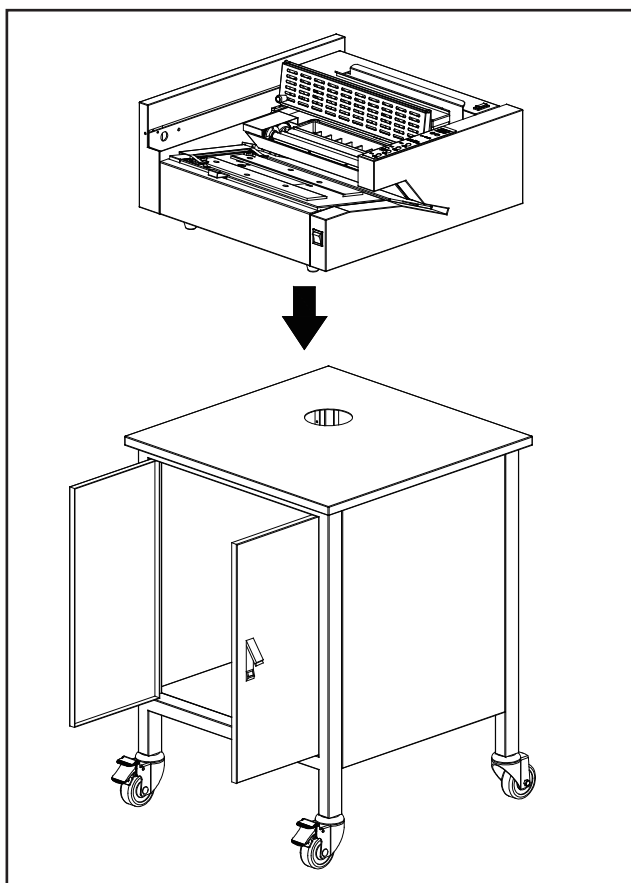

5-3-1 Turn on the machine

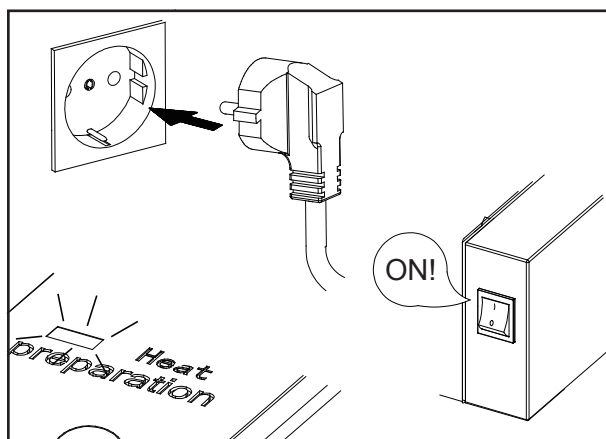

- Plug the power cord to outlet.
- Turn on the main switch.
- The Heat Preparation Lamp turns on, the machine is heating the glue in the melt tank.

5-3-2 Melt glue

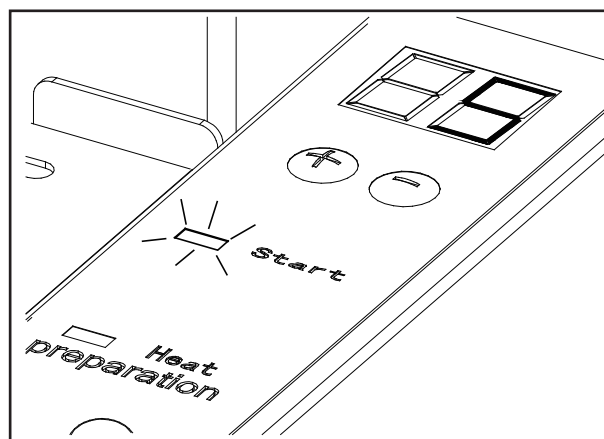

- Warming up time is about 20 minute.
- When Start lamp turns on, keep waiting 10 more minutes so that the glue in the melt tank can fully melted.

5-3-3 Depress Reset Button

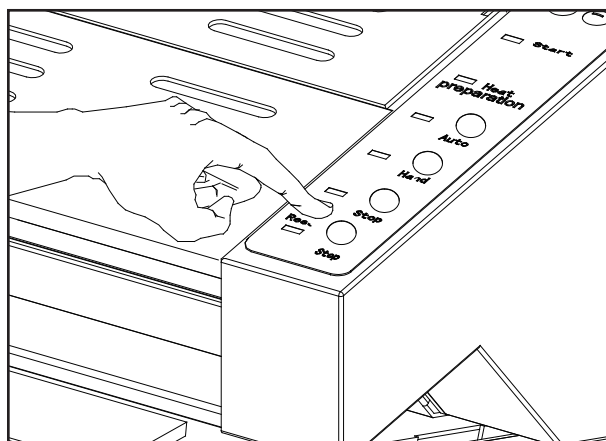

- Keep depressing Reset Button for about 5 seconds, the clammer will move forward and stop at the front position above the nipper.

5-3-4 Remove the back cover

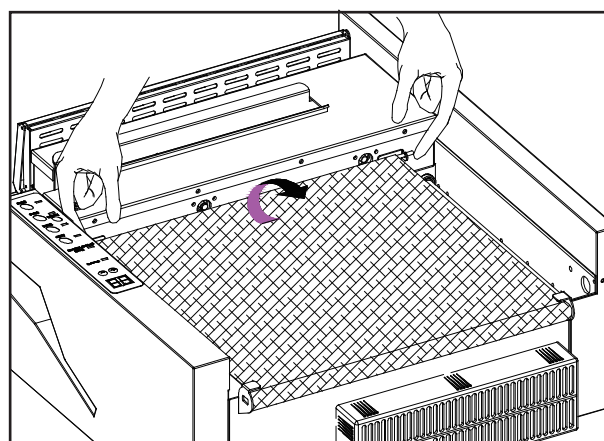

- Remove the back cover like above picture.
- Slowly get the back cover to the roller.

5-3-5 Melt tank and roughening cutter

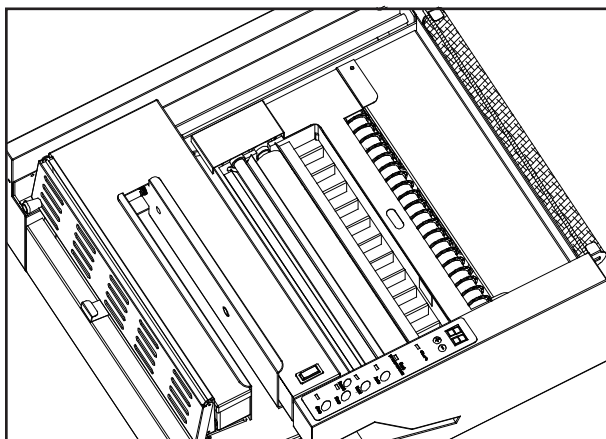

- We can see the melt tank and roughening cutter

[Warning]

- **Do not touch the roughening cutter and melt tank to avoid personal injury!**

5-3-6 Loosen the screw

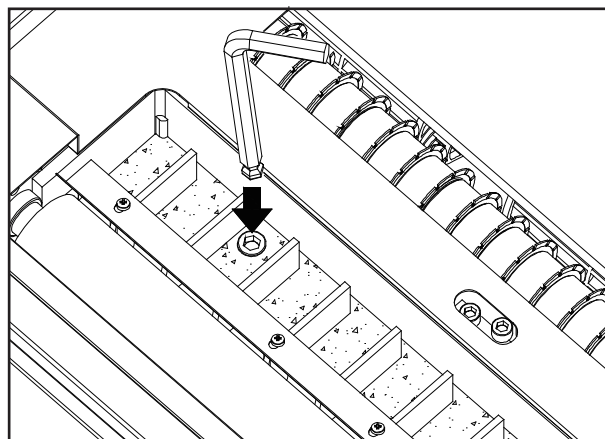

- Use Hexagonal wrench (See 1-2) to loosen the screw in the left hand side of melt tank.
- The glue in the melt tank leaks into the Stand Cabinet.

5-3-7 Leaking

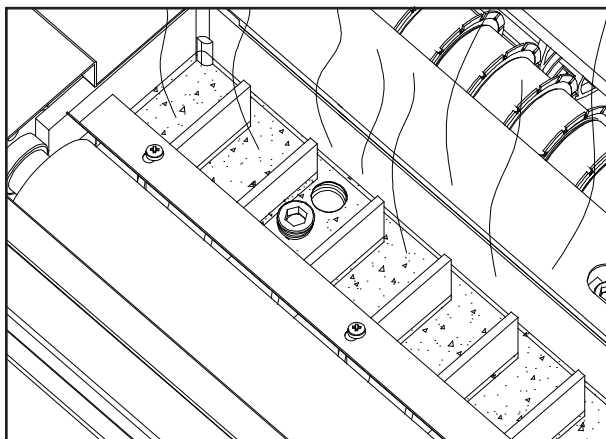

[Caution]

- **Keep track of the leaking process.**

5-3-8 Turn off the main switch

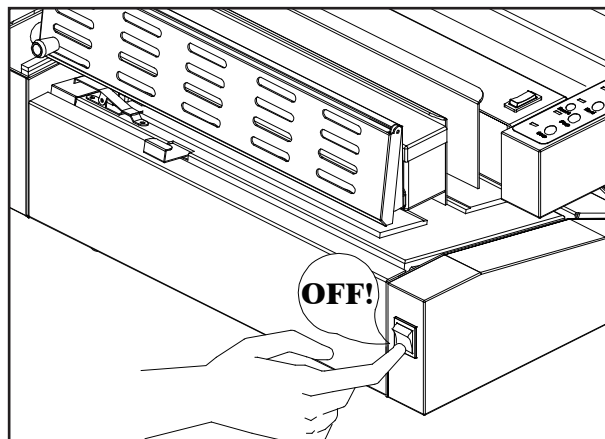

- When the glue level is below the Min. of Glue indicator, turn off the main switch.

[Caution]

- **Main Switch is On When No glue in Melt Tank May Burn The Machine!**

5-3-9 Secure the screw

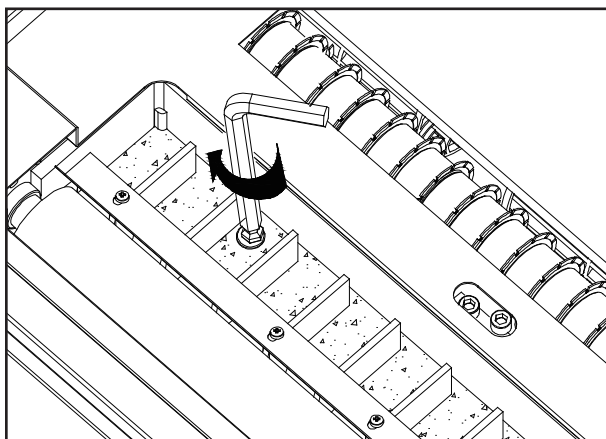

- When leaking finish, secure the screw.

5-3-10 Install the back cover

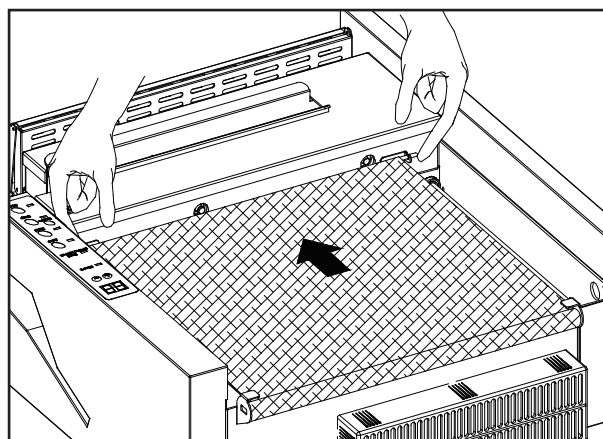

- Install the back cover .

5-3-11 Turn on the main switch

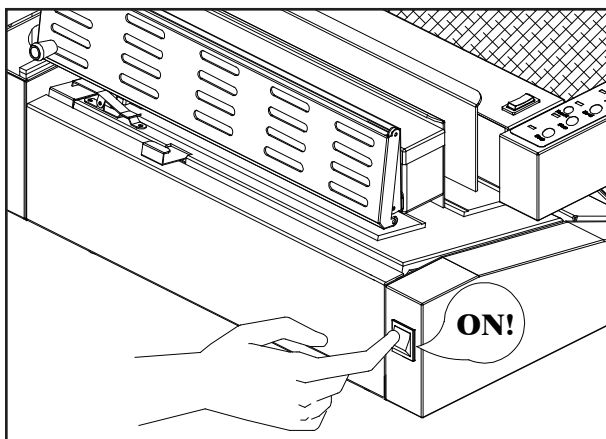

- Turn on the switch.
- Clamper returns to its home position.

5-3-12 Supply glue into Melt Tank

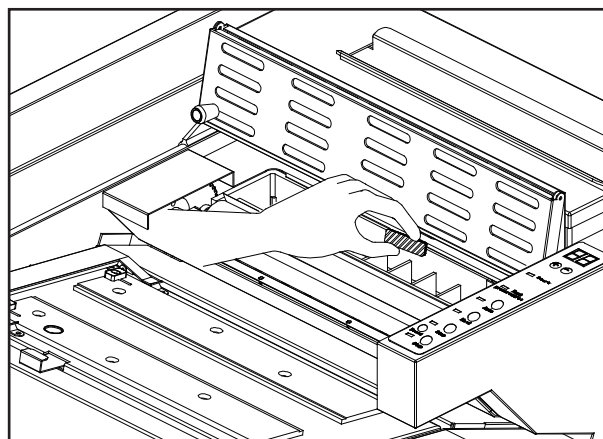

- Supply new glue into melt tank.
- Waiting glue to be melted.

6. Trouble Shooting

6-1 When turn on the machine, the lamps do not turns on

Countermeasure:

- (1) Please check whether the power cord have been plug to the outlet.
- (2) please check whether the fuse is good.

6-2 When you want to stop the binding process

Countermeasure:

- (1) Depress Stop Button.
- (2) Depress Reset Button, the clamper will return to its home position. The machine will jump to Hand mode.
- (3) Depress Open /Close clamper button to release the book and take out the book from the clamper.

6-3 When clamper does not move

Countermeasure:

- (1) Push the book to the left hand side of the clamper.
- (2) Place the cover on the nipper. For it must bind with a cover.

6-4 Lamps in the control panel is blinking or any other problems

Countermeasure:

Try to turn off the main switch and turn on the machine 1 minutes later.

6-5 Other situations you do not know how to handle, please contact your local dealer for repair.